



CABLE 089 RF: RF CABLE ASSEMBLY, HIROSE U.FL + RP SMA BULKHEAD JACK WITH O-RING + MULTIPLE CABLE SIZES

SPECIFICATIONS

1. HIROSE U.FL PLUG (SEE CHART FOR P/N)
2. COAXIAL CABLE (SEE CHART FOR DETAIL)
3. RP SMA BULKHEAD JACK WITH O-RING (SEE CHART FOR P/N)

NOTES:

1. THE ORIENTATION OF CONNECTORS ON DRAWING IS FOR REFERENCE ONLY, IF THE ORDER IS LEFT BLANK THE CONNECTOR WILL NOT HAVE FIXED ORIENTATION.
2. FIXED ORIENTATION IS POSSIBLE FOR CABLE LENGTH 25MM TO 220MM. PLEASE SPECIFY THE FIXED ORIENTATIONS FROM THE ORDER CODE (F1, F2, ETC)
3. CONTACT GRAD CONN IF THE ORIENTATION YOU REQUIRE IS NOT SHOWN.
4. WORKING FREQUENCY RANGE: DC-6GHz

USAGE PRECAUTIONS: CABLES USING 'MICRO' COAX ARE DELICATE:

- (i) HANDLE WITH CARE.
- (ii) DO NOT TWIST; APPLY EXCESSIVE FORCES OR SHARP BENDS TO THE CABLE. DO NOT FORCEFULLY DEFORM WIRES.
- (iii) CONSULT CONNECTOR MANUFACTURER'S DATASHEETS FOR DETAILED NOTES ON HANDLING INSTRUCTIONS.

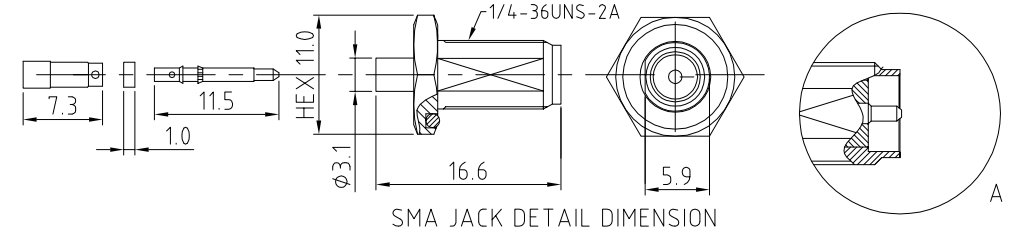
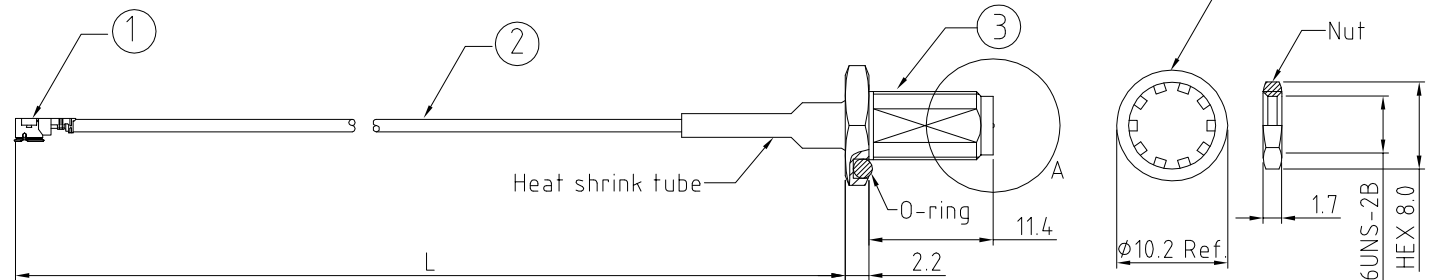
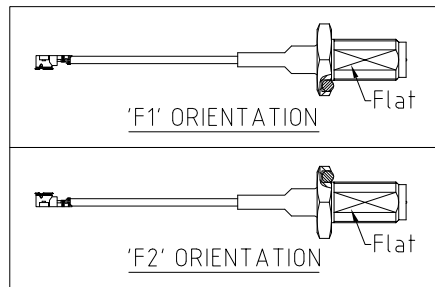

CHART OF CABLE AND CONNECTOR P/N

CABLE ϕ & COLOR	HIROSE P/N	SMA P/N
ϕ 1.13, GRAY	U.FL-LP-068	C20AD31113005B
ϕ 0.81, GRAY	U.FL-LP(V)-040	C20AD31081005B
ϕ 1.32 DS, GRAY	U.FL-LP-066	C20AD31132005B
ϕ 1.37, BLACK	U.FL-LP-088	C20AD31137005B



HOW TO ORDER

CABLE 089 RF - X X X - X X - X - X

"L" LENGTH IN MM
 eg: 100MM = 100
 (MIN. 025-MAX.400)
 STANDARD = 100, 150, 200
 Tolerance: <50mm : \pm 2mm.
 51-200mm: \pm 5mm.
 201-400mm: \pm 7mm.

CABLE SIZE OPTIONS:
 BLANK = ϕ 1.13MM CABLE
 1 = ϕ 0.81MM CABLE
 2 = ϕ 1.32MM DOUBLE SHIELDED CABLE
 3 = ϕ 1.37MM CABLE

WASHER AND NUT OPTIONS:
 BLANK = SEPERATELY PACKED (STANDARD)
 A = ASSEMBLED WITH CONNECTOR

BLANK = DOES NOT HAVE A FIXED ORIENTATION
 F1 = U.FL CONNECTION DOWN (L=25-220MM)
 F2 = U.FL CONNECTION UP (L=25-220MM)
 (SEE NOTES 1, 2, 3 AND DIAGRAMS FOR MORE INFORMATION)

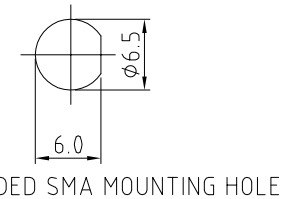

REV. DATE & DRN
 10 09/17/09-NYW RELEASE
 11 11/11/09-NYW
 12 22/03/10 - NYW ADD ORIENTATION OPTION
 13 13/06/14 - NYW ADD MULTIPLE CABLE SIZES.
 14 10/07/19 - NYW ADD NOTES 5-7.
 15 08/07/19 - NYW AMEND 132 CABLE DES.
 REMOVE NOTES 5-7.

Scale: NTS	THIRD ANGLE	Unstated X XX XXX ANGLES	Tolerances: N/A N/A N/A N/A	Material SEE NOTE
Drawn: NYW		Title CABLE ASSEMBLY		NOT TO SCALE
App'd: XXX	Revision: 15		Unit: mm	
Date: 8 JUL '19				

THIS DRAWING IS CONFIDENTIAL AND MUST NOT BE COPIED OR DISCLOSED WITHOUT WRITTEN CONSENT

Type: Cable 089 RF
CABLE 089 RF
Drawing Number:
Sheet 1 of 1
Drawing © E and O E